

# DENSO

WIRELESS SCANNER

# NEW > SE1 SERIES



2D code model  
SE1-QB



Barcode model  
SE1-BB



**Data entry to smart devices is now easier, quicker and more accurate!**

iOS   Android   Windows® **supported!**

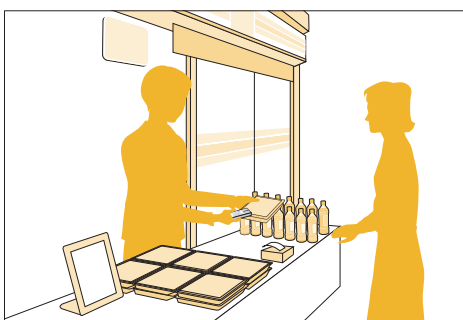

**Simplifies POS use at stores**

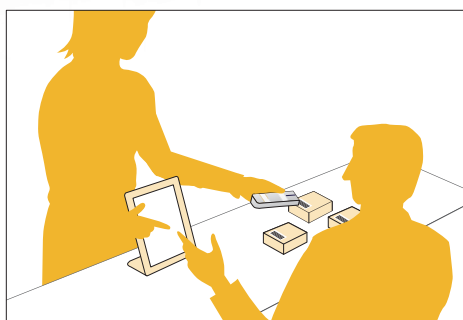

**For route salespersons**



**Helps prevent medical errors in hospitals**

### Feature 1

#### Long operation

This scanner can be operated for a long time, reducing operating costs. Even if suddenly out of battery power, there's no need to worry; this scanner is battery-powered.



### Feature 2

#### Supports LCD scanning

Scanning codes displayed on a smartphone or other device is also supported.



### Feature 3

#### Connects to all detected Bluetooth® devices

No complicated settings required. Do settings by just scanning the connection code.

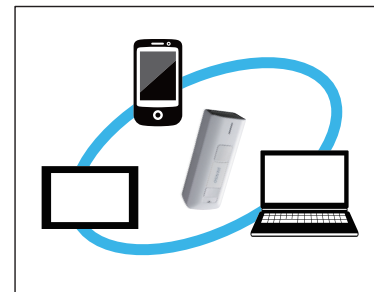

### SE1 series specifications

		2D code model		Barcode model	
Type		SE1-QB		SE1-BB	
Scanner		Area sensor		Advanced scan plus (CCD)	
Mode	Readable codes	2D code	QR code, micro QR code, iQR, SORC, PDF417, DataMatrix (ECC200), Aztec, GS1 Composite (EAN, UCC Composite), Maxi Code	-	
		Barcode	EAN-13/8 (JAN-13/8), UPC-A/E, UPC/EAN (with add-on), Interleaved 2 of 5 (ITF), CODABAR (NW-7), Standard 2 of 5 (STF), CODE39, CODE93, CODE128, GS1-128 (EAN-128), GS1 DataBar (RSS)	EAN-13/8 (JAN-13/8), UPC-A/E, UPC/EAN (with add-on), Interleaved 2 of 5 (ITF), CODABAR (NW-7), CODE32, CODE39, CODE93, CODE128, GS1-128 (EAN-128), GS1 DataBar (RSS), Standard 2 of 5 (STF), MSI, Plessey	
	Minimum resolution	2D code	0.167 mm	-	
		Barcode		0.125 mm	
	PCS value			0.3 min.	
	Angle			±50°	
Scanning confirmation			Confirmation LED (blue, red), Buzzer		
Communication interface	Method	Bluetooth ver. 2.1 + EDR-based class 2			
	Profile	SPP, HID			
Power	Power	Alkaline AA battery x 2 or AA Eneloop® battery x 2			
	Operating time*1	50 hours		100 hours	
Environment requirements	Security level	IPX2			
	Drop impact resistance*2	1.2 m high over a concrete floor with 6 times			
	Operating temperature	-5~50°C			
Weight	Approx. 60 g (not including batteries)				

\*1: With one reading pass over a 5 s period.

\*2: These are test values, but not guaranteed values.

### Product configuration

#### Accessories

- Scanner
- Operation Guide (with code menu for settings)
- \* Batteries are not included.

#### Software

- Setting software (Scan Tune App)
- Software application to prepare parameter setting codes for SE1 series on PC.
- \* Downloadable via QDirect.

#### Option (sold separately)

- Neck strap (NSBHT-500)
- Hand strap (HSSE1)

#### Silicone cover

- Silicone cover common to SE1-BB and -QB (Clear)
- Silicone cover common to SE1-BB and -QB (Black)

### Dimensions

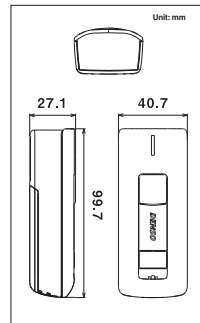

### Scanning performance

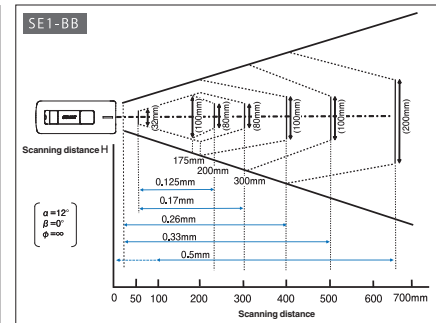
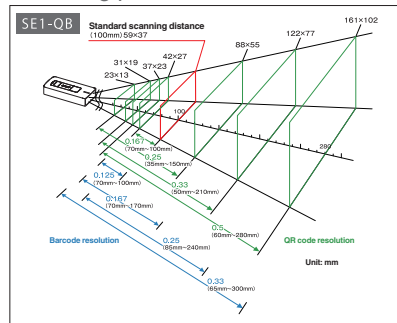

#### To use this product safely

- Before using this product, please read its User's Manual thoroughly for correct use.

For more information, please visit our website  
<http://www.denso-wave.com/en/adcd/>



QR Code is registered trademark of DENSO WAVE INCORPORATED.  
 ● Appearance and specifications are subject to change without prior notice. ● Description stated in this catalogue is as of July, 2014.